

Licensing Act 2003  
**Premises Licence**

**LEIPRM1277**



Leicester  
City Council

Local Services & Enforcement  
 Leicester City Council  
 York House  
 91 Granby Street  
 Leicester  
 LE1 6FB

(0116) 4543040  
[licensing@leicester.gov.uk](mailto:licensing@leicester.gov.uk)

Part 1 - Premises Details

POSTAL ADDRESS OF PREMISES, OR IF NONE, ORDNANCE SURVEY MAP REFERENCE OR DESCRIPTION

**Quality Superstore**

52 - 54 Catherine Street, Leicester, LE4 6BB.

WHERE THE LICENCE IS TIME LIMITED THE DATES

Not applicable

Expires **no expiry**

LICENSABLE ACTIVITIES AUTHORISED BY THE LICENCE

- the supply of alcohol

THE TIMES THE LICENCE AUTHORISES THE CARRYING OUT OF LICENSABLE ACTIVITIES

Activity (and Area if applicable)	Description	Time From	Time To
J. Supply of alcohol for consumption OFF the premises only	Mon-Sat	8:00am	10:00pm
	Sunday	10:00am	8:00pm

THE OPENING HOURS OF THE PREMISES

Description	Time From	Time To
Mon-Sat	8:00am	10:00pm
Sunday	10:00am	8:00pm

WHERE THE LICENCE AUTHORISES SUPPLIES OF ALCOHOL WHETHER THESE ARE ON AND / OR OFF SUPPLIES

- J. Supply of alcohol for consumption OFF the premises only

Part 2

NAME, (REGISTERED) ADDRESS, TELEPHONE NUMBER AND EMAIL (WHERE RELEVANT) OF HOLDER OF PREMISES LICENCE

Quality Superstore Leicester Ltd

Desai House, 9-13 Holbrook Lane, Coventry, CV6 4AD.

REGISTERED NUMBER OF HOLDER, FOR EXAMPLE COMPANY NUMBER, CHARITY NUMBER (WHERE APPLICABLE)

Quality Superstore Leicester Ltd

8871373



Licensing Act 2003

# Premises Licence

# LEIPRM1277



Leicester  
City Council

Local Services & Enforcement  
Leicester City Council  
York House  
91 Granby Street  
Leicester  
LE1 6FB

(0116) 4543040  
[licensing@leicester.gov.uk](mailto:licensing@leicester.gov.uk)

## NAME, ADDRESS AND TELEPHONE NUMBER OF DESIGNATED PREMISES SUPERVISOR WHERE THE PREMISES LICENCE AUTHORISES THE SUPPLY OF ALCOHOL

Manmeet Singh KHANEJA

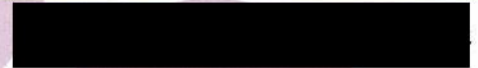

## PERSONAL LICENCE NUMBER AND ISSUING AUTHORITY OF PERSONAL LICENCE HELD BY DESIGNATED PREMISES SUPERVISOR WHERE THE PREMISES LICENCE AUTHORISES FOR THE SUPPLY OF ALCOHOL

Licence No. LEIPRS3611

Issued by Leicester

## ANNEXES

### Annex 1 - Mandatory conditions

No supply of alcohol may be made under the premises licence -

- a) at a time when there is no designated premises supervisor in respect of the premises licence, or
- b) at a time when the designated premises supervisor does not hold a personal licence or his personal licence is suspended.

Every supply of alcohol under the premises licence must be made or authorised by a person who holds a personal licence.

The premises licence holder or club premises certificate holder must ensure that an age verification policy is adopted in respect of the premises in relation to the sale or supply of alcohol.

The designated premises supervisor in relation to the premises licence must ensure that the supply of alcohol at the premises is carried on in accordance with the age verification policy.

The policy must require individuals who appear to the responsible person to be under 18 years of age (or such older age as may be specified in the policy) to produce on request, before being served alcohol, identification bearing their photograph, date of birth and either-

- a) a holographic mark, or
- b) an ultraviolet feature.

A relevant person shall ensure that no alcohol is sold or supplied for consumption on or off the premises for a price which is less than the permitted price.

### Annex 2 - Conditions consistent with the operating schedule

The licence holder will ensure that proof of age is requested when necessary e.g passport, driving licence or citizen card

The licence holder will ensure that they have a refusal book,

The licence holder will ensure that children are restricted on the premises

The licence holder will ensure Health and Safety is complied with at all times

The licence holder will ensure that rubbish bins and glass refuse are kept at the rear of the premises

The licence holder will ensure that windows and doors will be closed if it causes too much nuisance

### Annex 3 - Conditions attached after a hearing by the Licensing Authority

None



Portugal Mini Market  
52-54 Catherine Street  
Leicester  
LE4 6BB

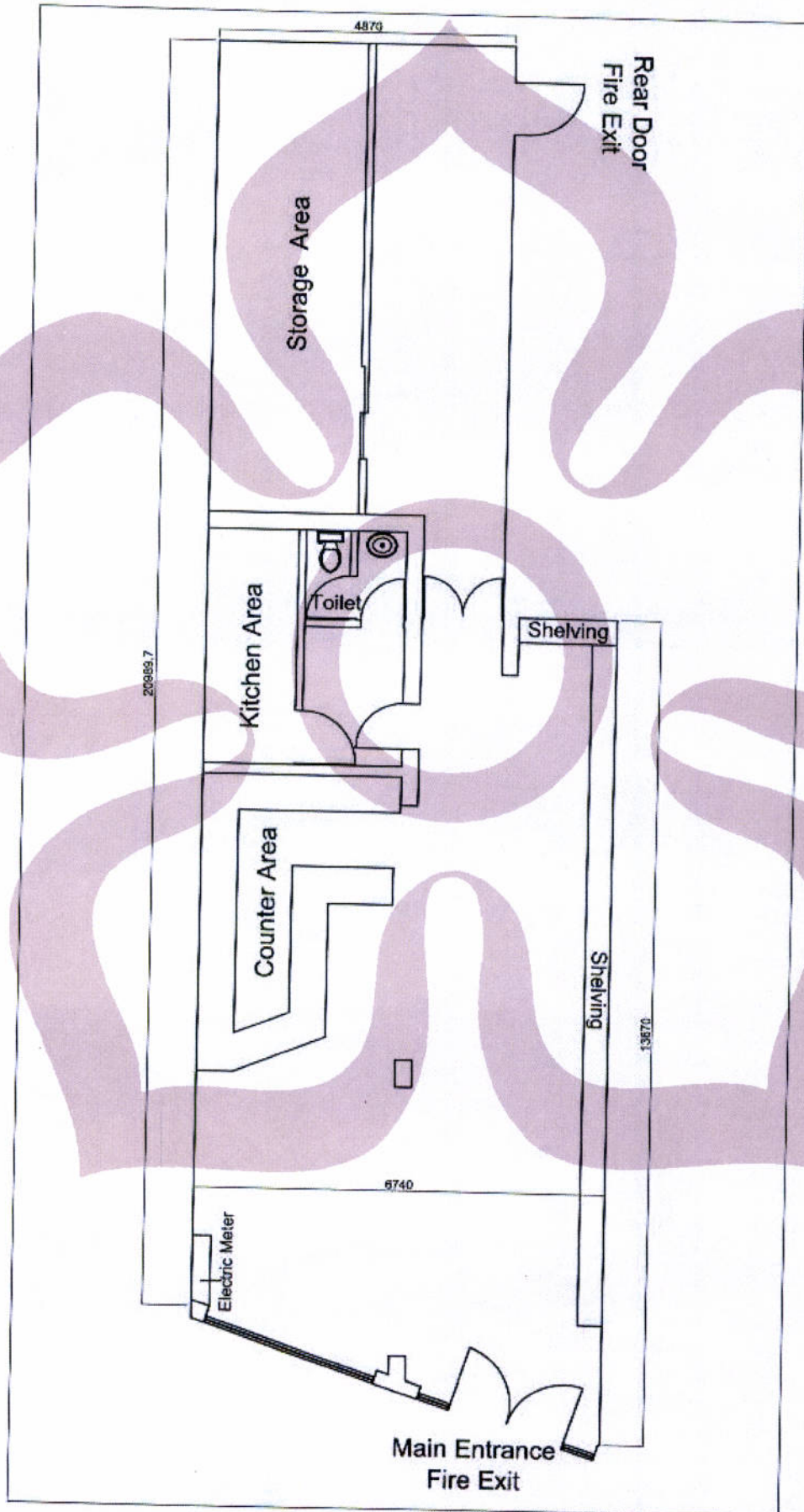

Plan  
Scale 1/100



Leicester  
City Council

Local Services & Enforcement  
Leicester City Council  
York House  
91 Granby Street  
Leicester  
LE1 6FB

(0116) 4543040  
[licensing@leicester.gov.uk](mailto:licensing@leicester.gov.uk)

## Premises Details

## POSTAL ADDRESS OF PREMISES, OR IF NONE, ORDNANCE SURVEY MAP REFERENCE OR DESCRIPTION

**Quality Superstore**

52 - 54 Catherine Street, Leicester, LE4 6BB.

## WHERE THE LICENCE IS TIME LIMITED THE DATES

Not applicable

## LICENSABLE ACTIVITIES AUTHORISED BY THE LICENCE

- the supply of alcohol

## THE TIMES THE LICENCE AUTHORISES THE CARRYING OUT OF LICENSABLE ACTIVITIES

Activity (and Area if applicable)	Description	Time From	Time To
J. Supply of alcohol for consumption OFF the premises only	Mon-Sat	8:00am	10:00pm
	Sunday	10:00am	8:00pm

## THE OPENING HOURS OF THE PREMISES

Description	Time From	Time To
Mon-Sat	8:00am	10:00pm
Sunday	10:00am	8:00pm

## WHERE THE LICENCE AUTHORISES SUPPLIES OF ALCOHOL WHETHER THESE ARE ON AND / OR OFF SUPPLIES

- J. Supply of alcohol for consumption OFF the premises only

## NAME, (REGISTERED) ADDRESS OF HOLDER OF PREMISES LICENCE

Quality Superstore Leicester Ltd

Desai House, 9-13 Holbrook Lane, Coventry, CV6 4AD.

## REGISTERED NUMBER OF HOLDER, FOR EXAMPLE COMPANY NUMBER, CHARITY NUMBER (WHERE APPLICABLE)

Quality Superstore Leicester Ltd

8871373

## NAME OF DESIGNATED PREMISES SUPERVISOR WHERE THE PREMISES LICENCE AUTHORISES THE SUPPLY OF ALCOHOL

Manmeet Singh KHANEJA



Licensing Act 2003

# Premises Licence Summary

# LEIPRM1277



Leicester  
City Council

Local Services & Enforcement  
Leicester City Council  
York House  
91 Granby Street  
Leicester  
LE1 6FB

(0116) 4543040  
[licensing@leicester.gov.uk](mailto:licensing@leicester.gov.uk)

STATE WHETHER ACCESS TO THE PREMISES BY CHILDREN IS RESTRICTED OR PROHIBITED

